

**Safety pedal FL1-528-ZSD4-U**

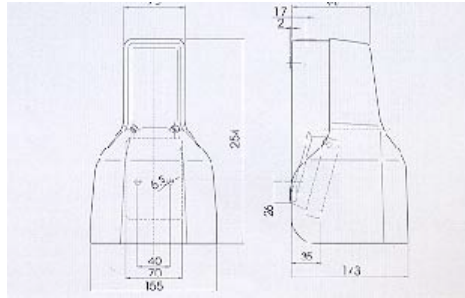

The pedals FL1-528-ZSD4-U use safety switches. The foot actuator has 3 positions, with a hard point, to control dangerous movements (for instance get down of a press brake ect...). It has 4 working contacts (2NC+2NO) to drive the movement and a block of 2 safety switches (1 positively driven NC contact + 1NO) to stop the movement. Pressing on the foot actuator, till the hard point, allows the changeover of the 4 working contacts. Once the hard point is got over, the 4 working contacts return to their first position and the 2 contacts block is activated in order to stop immediately the dangerous movement. Then it would be possible to drive one more time the movement after the right foot actuator is completely loosed. This function allows stopping immediately the machine even if the operator is carried along in front by the dangerous movement.

**TECHNICAL DATA:**

**MECHANICAL:**

Housing: Die cast aluminium AL Si 12 – paint colour grey like RAL 7001  
Cover/protective hood: Die cast Aluminium AL Si 12 - paint colour red like RAL 3000

Foot actuator: Reinforced thermoplastic PA 6.6 – black  
Service temperature: -30°C à +70°C  
Mechanical service life: 10<sup>6</sup> operations min  
Cable entry: PG13, 5 (It is recommended to fix the cable with one cable gland)

**ELECTRICAL:**

	Before hard point	After hard point
Contact:	2NO + 2NC	1NO + 1positively driven NC
Switching element:	Snap-action switch	Slow-action switch
Connection type:	Solder post	Screw terminal
Operating voltage:	Max 250V~	Max 250V ~
Switching current:	Max 5A	220V/0,5A 24V/6A

Switching diagram:

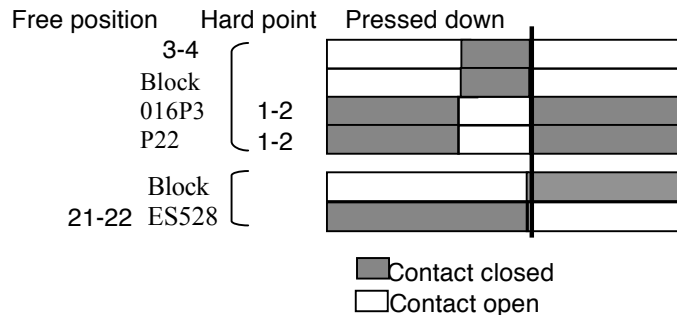

Switching elements:

